



## Tsubame TAC400SC-6B5 trailer diesel air compressor

400 CFM @ 100 psi.

**Key Features:** Road-legal Single-axle Australian made trailer, mine-spec build, fast site deployment

Tsubame Air's Australian made trailer diesel compressors deliver reliable air power built on precision Japanese engineering and tailored for Australia's harsh conditions. Worksite All-Rounder.

- Kubota 4-cylinder diesel, 178L fuel tank
- Steady airflow for multiple heavy tools
- Very low noise and emissions
- Full-service access via gullwing doors
- Leak Guard base available for spill control

Optional Upgrades: mine-spec safety kit, heavy-duty filters, trailer kit, remote start, after-cooler

Applications: Pipeline projects, civil works, mining, mobile plant air.

Rental SPEC Inclusions: Aftercooler, Exhaust Pipe Rain Cap, Exhaust Heat Tape, Spark Arrestor, Heavy Duty Environmental Containment Base, Set & Certified Pressure Relief Valves, Pressure Vessel Inspection & Certification, Certified Lifting Point, Pressure Relief Radiator Cap, isolators, fire extinguisher, e-stop, reflective tape, exhaust cover, document holder,

**Minsup Type A Fittings Installed**

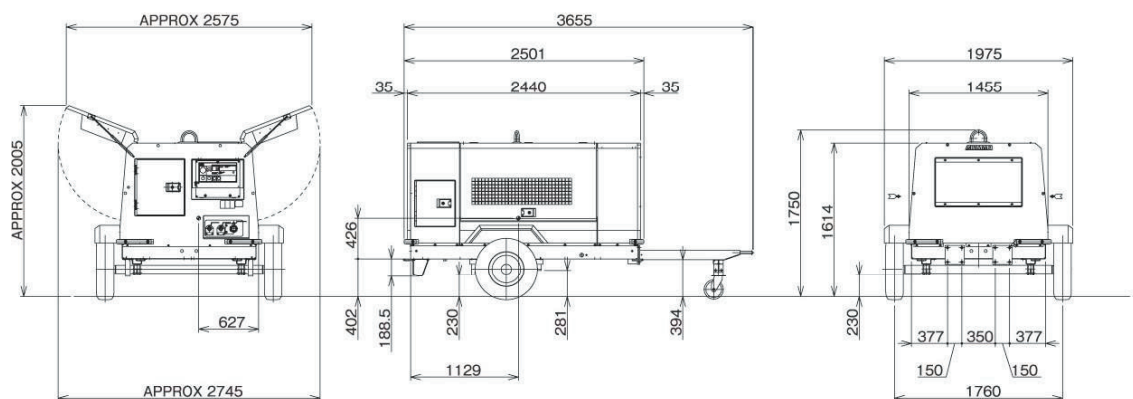

## Tsubame TAC400SC-6B5 trailer diesel air compressor

400 CFM @ 100 psi.

Parameter	Specifications
COMPRESSOR TYPE	Single-Stage, Oil-cooled, rotary twin screw type
PRESSURE 400CFM @ 100 PSI	
ACTUAL FREE AIR DELIVERY	11.3 m <sup>3</sup> /min 400 cfm
WORKING PRESSURE	700 kPa 100 psi (g)
WORKING PRESSURE (MAX)	825 kPa 120 psi (g)
COMPRESSOR LUBRICATING OIL CAP	40 litres
COMPRESSOR LUBRICATING SYSTEM	Forced Lubrication by Compressed Air
DRIVING SYSTEM	Direct Drive Gear Coupled
AIR SERVICE VALVES	1x2", x2 x3/4"
OIL COOLER TYPE	Air Pressurised Tube & Fin
COMPRESSOR OIL FILTER	Spin-on Cartridge Type
SOUND dBA RATING @ 7m	71 dBA
ENGINE MAKE & MODEL	Kubota V3800DI-TIE2B-COHE1
ENGINE TYPE	Direct Injection
ASPIRATION	Naturally Aspirated
NUMBER OF CYLINDERS	4
ENGINE DISPLACEMENT	3,769 cc
HORSEPOWER RATING (@3,000 RPM)	102.2 (75.2)kW
FUEL	Diesel / Biofuel B5
FUEL TANK CAPACITY	178 Litres
FUEL FILTER QUANTITY / TYPE	1 cartridge
FUEL PUMP	Self air bleed
EMISSIONS RATING	Stage 2
ENGINE OIL CAPACITY	13 Litres
COOLANT CAPACITY	15.6 Litres
ELECTRICAL SYSTEM - VOLTAGE	12 Volt
BATTERY GROUP	130F5I
FUEL CONSUMPTION:	
FULL LOAD	19.7 l/hr
70% LOAD	13.2 l/hr
NO LOAD	6.6 l/hr
RUNTIME (FULL LOAD/ 70% LOAD)	9.0 / 13.5 Hrs
Dimensions (LxWxH)	3665 x 1975 x 1775 mm
Dry Weight kg	1820 (2020)